

## Tools/Equipment Required:

- 19mm wrench
- torque wrench capable of setting 80 N-m (59 ft-lb)
- grease or petroleum jelly (optional)
- PTO Kit from Linde

## Procedure to Install a PTO Kit:

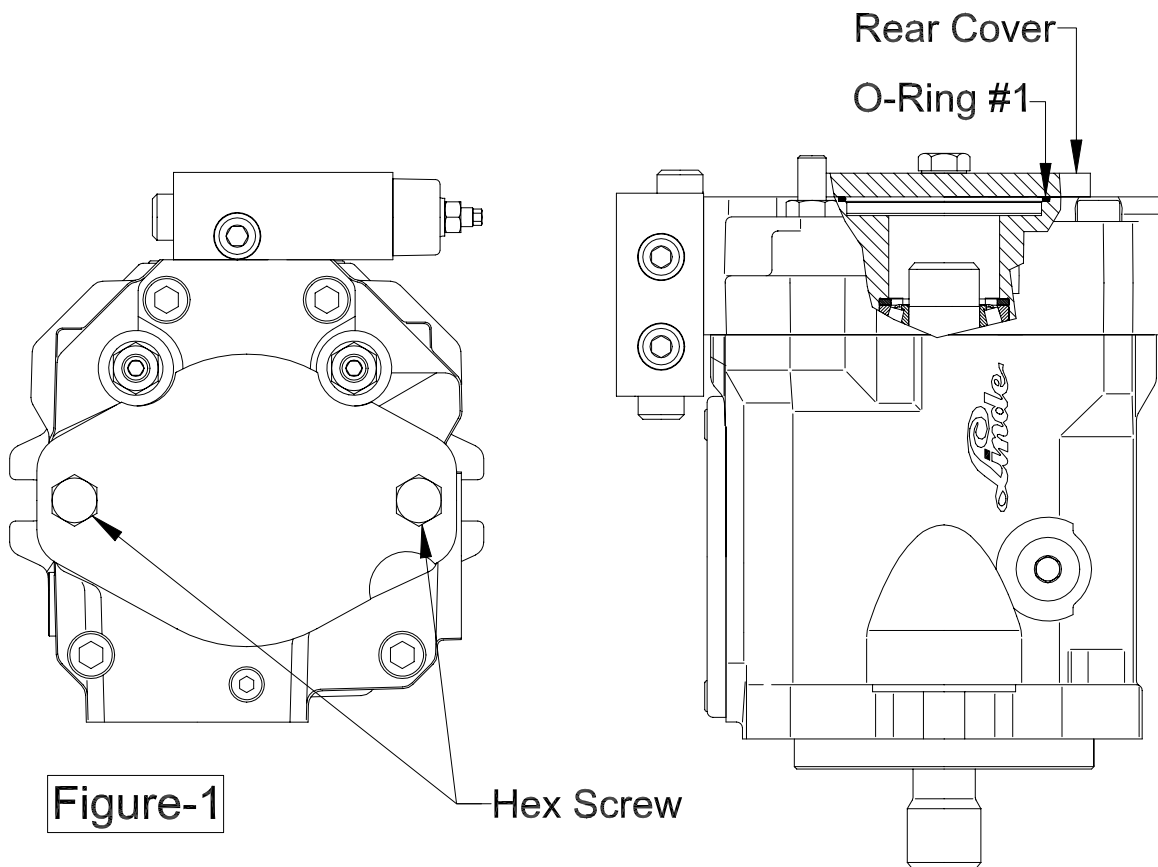
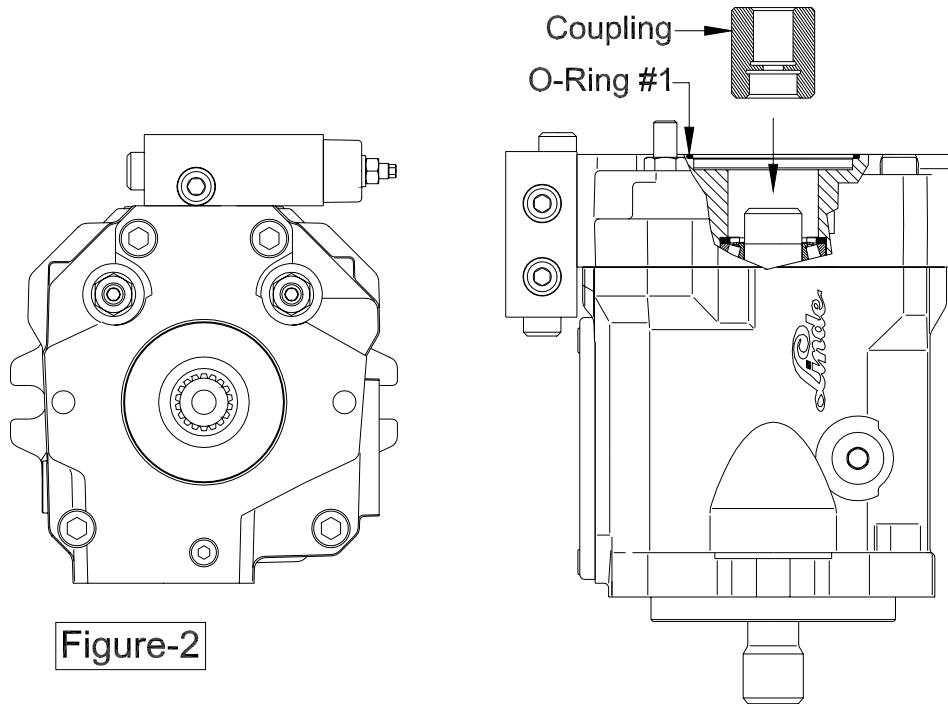

Figure-1

Hex Screw

1. Remove the two *Hex Screws* with the 19mm wrench. Discard them once removed.
2. Remove the *Rear Cover* from the back of the pump. Keep it for reuse.
3. Make sure that *O-Ring #1* is in good condition (i.e. undamaged). Keep it for reuse.
4. Insert the *Coupling* onto the tailspline of the pump drive shaft as illustrated below in "Figure-2".

**Figure-2**

5. Make sure that *O-Ring #1* is properly positioned in the o-ring groove as illustrated above in "Figure-2". You can use a little grease or petroleum jelly to hold *O-Ring #1* in place.

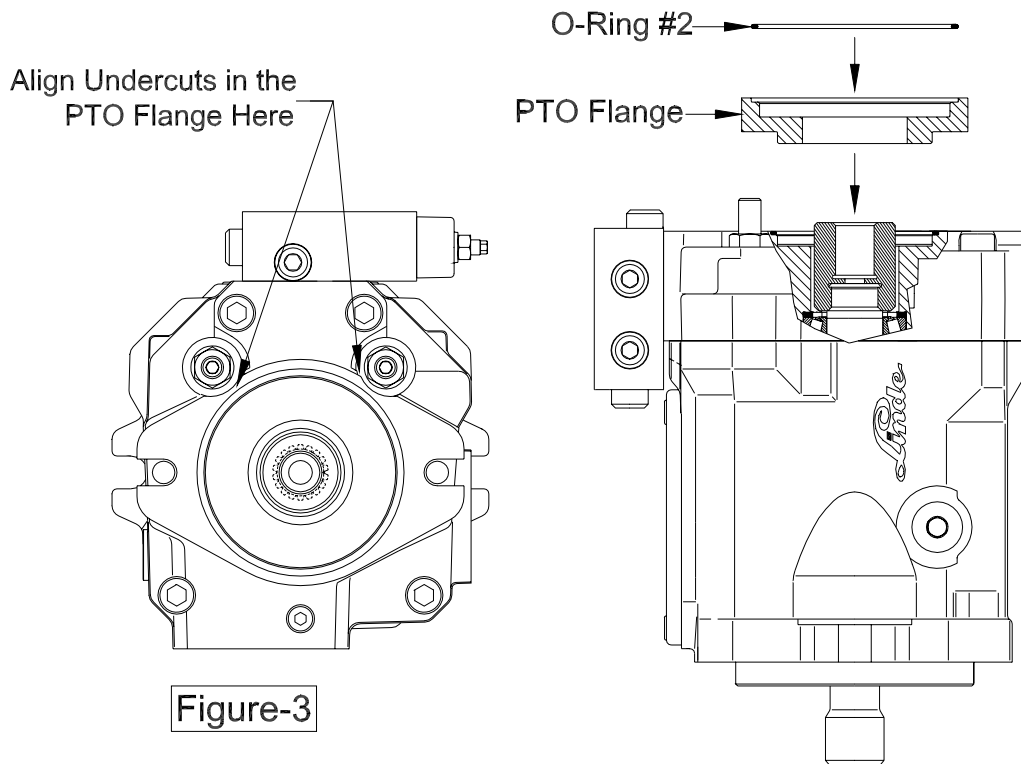
**Figure-3**

6. With *O-Ring #1* properly positioned, install the *PTO Flange* onto the rear of the pump as illustrated above in "Figure-3".
7. Install *O-Ring #2* into the o-ring groove of the *PTO Flange*. You can use a little grease or petroleum jelly to help hold *O-Ring #2* in place.

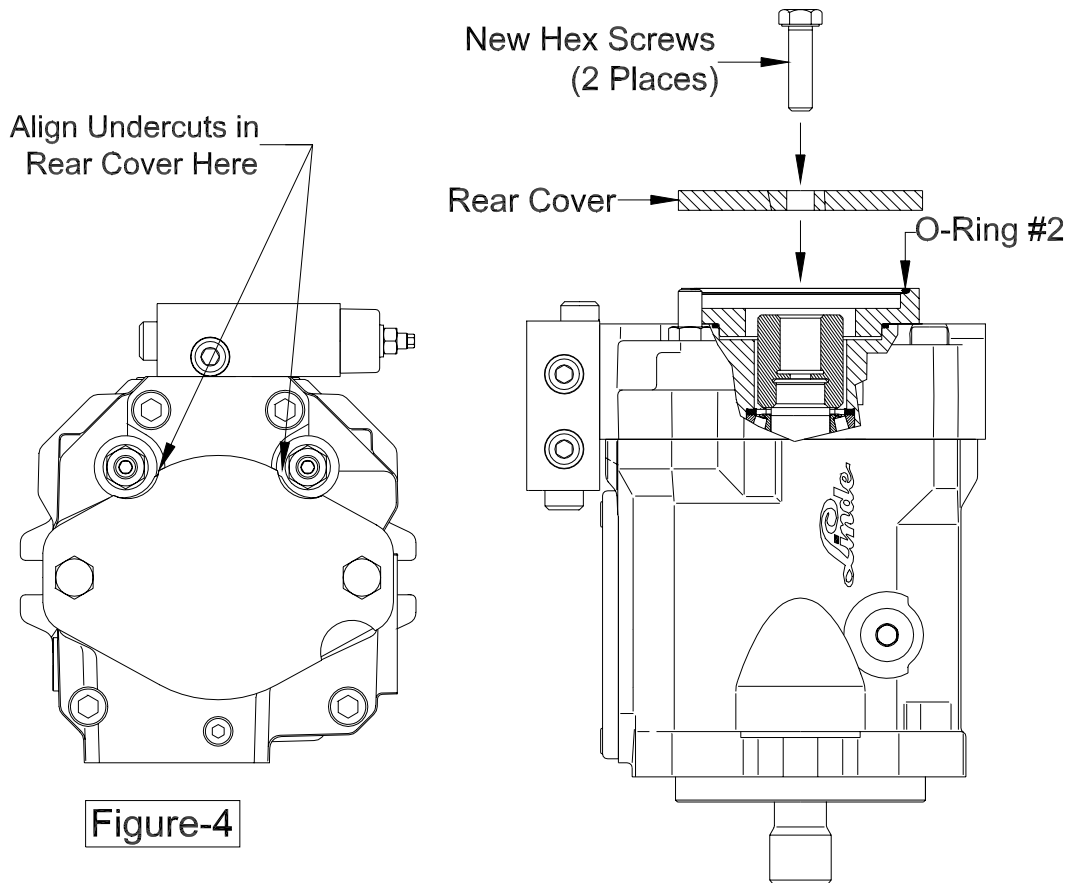

8. With *O-Ring #2* properly positioned, reinstall the *Rear Cover* from step #2 as illustrated above in "Figure-4".
9. Fasten the *Rear Cover* with the *New Hex Screws*.
10. Tighten the *New Hex Screws* with the 19mm wrench and torque each one to 80 N-m (59 ft-lb).



**\*\*\*\*\*ATTENTION\*\*\*\*\***

You have been provided information on conversion, repair and/or service of Linde components. Proper application of the information requires specific training and may require use of specialized tooling and equipment. If you choose to proceed with the conversion, repair and/or service of the Linde component(s) absent the necessary training and/or these specialized tools, you do so at your risk.

Linde Hydraulics Corporation will accept no claim for warranty or other consideration resulting from deficiencies in the conversion, repair and/or service done in accordance with the guidance offered herein when the necessary training has not been conducted and/or required specialized tooling and equipment has not been utilized.

All requests for training must be coordinated through your Linde Account Manager. He can also provide you price and availability of any specialized tooling.

Questions regarding the information provided or this disclaimer should be addressed to the Warranty & Service Department, Linde Hydraulics Corporation.

5089 Western Reserve Road  
Canfield, OH 44406  
330.533.6801 (Telephone)  
330.533.9873 (Facsimile)  
[www.lindeamerica.com](http://www.lindeamerica.com) (Web Site)